

I-MACH | 緊湊 靈活 高效

Compact. Flexible. Efficient.



兩板注塑機系列 CE

TWO PLATEN HYDRAULIC PLASTIC
INJECTION MOULDING MACHINE SERIES

Clamping Force 35–350T

I-MACH

Compact. Efficient. Flexible.

I-MACH Series offers clean, flexible, cost saving solution for variety of applications. For a compact and space efficient solution, IMACH offers hydraulic two platen clamping. To ensure precision for users, IMACH is equipped with ST series single cylinder injection system.

I-MACH系列提供乾淨、靈活、節約營運成本的優質方案，適應廣泛的應用。二板設計提供更有效的空間效率、更平均的鎖模結構。I-MACH同時具備ST單缸射膠系統，確保高射膠精密度。

Clamping Force 35-350T



Compact

- Two platen clamping design ensure space saving, and automation flexibility.
- Guard board design for easy maintenance, high safety level and featured in-guard automation space.

緊湊

- 兩板式設計確保空間節省和自動化靈活性
- 保護板設計易於維護，安全性高，板金內自動化空間靈活

Efficient

- Energy saving servo hydraulic system
- User friendly controller and software

高效

- 節能伺服液壓系統
- 簡單易用歐洲的技術

Flexible

- Flexible choice of single cylinder injection unit size for variation application
- High performance software and controller suitable for advanced application

靈活

- 靈活選擇單缸注射單元尺寸以適應不同的應用
- 高性能軟件和控制器適用於高級應用

CLAMPING UNIT 鎖模部份	項目	Items	Unit	I-MACH 35								
	鎖模力	Mould Locking Force	kN	350								
	開模力 (高壓)	Mould Unlocking Force	kN	44.3								
	移模力 (鎖模)	Mould Close Force	kN	26.3								
	移模力 (開模)	Mould Open Traverse Force	kN	18								
	最大鎖模行程	Max. Mould Open Stroke	mm	350								
	最小容模厚度	Min. Mould Height	mm	175								
	最大容模厚度	Max. Mould Height	mm	N/A								
	模板最大開距	Max. Daylight	mm	525								
	四柱內距 (水平 x 垂直)	Space Between Tie-bars (HxV)	mm	320 x 320								
	模板尺寸	Platen Size (HxV)	mm	500 x 500								
	哥林柱直徑	Diameter of Tie-bars	mm	45								
	頂針力	Ejector Force, Forward/Retract	kN	34.6/23.7								
	最大頂針行程	Max. Ejector Stroke	mm	80								
最大移模速度, 開模 / 鎖模	Max. Velocity (Open/Close)	mm/sec	816/557									
最大模具重量	Max. Mould Weight - Total/Moving platen	kg	500/300									
INJECTION UNIT 注射部份	射台型號	Injection Unit		ST125			ST180			ST245		
	螺桿直徑	Screw Diameter	mm	23	25	28	25	28	32	28	32	36
	理論注射容積	Swept Volume	c.c	41	54	67	61	77	101	86	112	142
	注射重量 (PS)	Shot Weight (PS)	g	43	51	64	55	70	91	78	102	129
	注射壓力	Specific Injection Pressure	bar	2679	2268	1808	3087	2460	1884		2260	1785
	高注射率	Injection Rate	c.c/sec	66	77	96	56	71	92	59	77	98
	注射速度	Injection Velocity	mm/sec	157			115			96		
	塑化能力 (PS)	Plasticizing Capacity (PS)	g/sec	7.9	9.7	12.8	9.7	12.8	18.6	9.9	14.4	20.4
	螺桿長徑比	Screw L:D Ratio	L/D	23	20	17.8	22.4	20	17.8		20	17.8
	注射行程	Screw Stroke	mm	115			125			140		
	螺桿轉距	Screw Torque	Nm	320			403			503		
	螺桿轉速	Screw Speed	r.p.m.	10-518			10-356			10-285		
	射咀接觸力	Nozzle Sealing Force	kN	37.71			37.71			37.71		
	射咀行程	Nozzle Retract Stroke	mm	220			220			220		
電熱功率	Heating Capacity of Barrel	kW	4			4.5			5.5			
加熱區的數量	Number of Heating Zones & Barrel	qty	3 + N			4 + N			4 + N			
OTHERS 其他	油泵電機功率	Rated Power of Pump Drive Servo Motor	kW	11								
	油箱容積	Oil Filling	l	150								
	液壓系統壓力	Hydraulic System Pressure	bar	175								
	機器重量	Machine Weight, Dry	Tons	1.7			1.8			1.8		
	外形尺寸 (LxWxH)	Machine Dimensions (LxWxH)	m	3.04x1.16x1.89			3.14x1.16x1.89			3.24x1.16x1.89		
幹循環時間	Dry Cycle Time (EUROMAP 6)	mm-sec	245-1.4									
國際尺寸評級	International Size Rating (EUROMAP)	ref	350H-128			350H-189			350H-254			

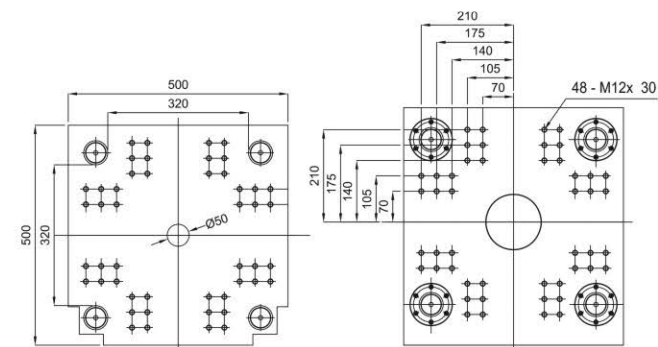
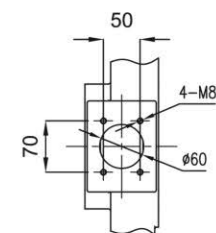
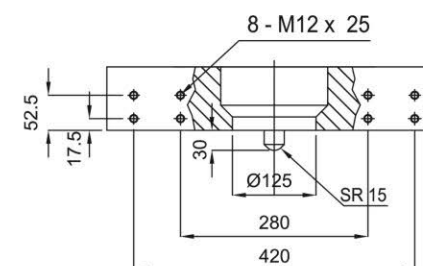
 模板尺寸
Platen Dimension

 落料口尺寸
Feeding Hole Dimension

 機械手安裝孔尺寸
Extractor Assembling Hole Dimension

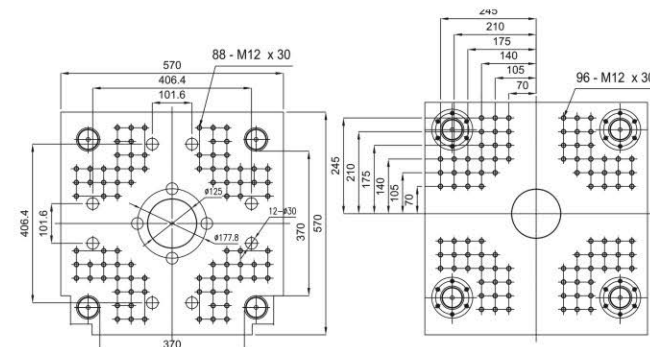
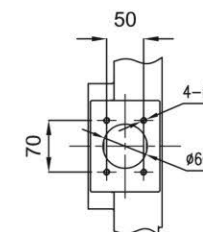
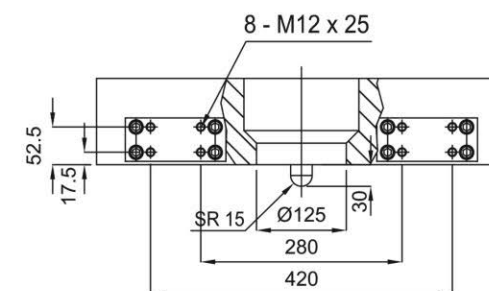
• 最小模具尺寸 (mm) 為 220x220 / Smallest tolerable mould dimension: 220x220 (mm)
 • 本公司可以隨時修改以上技術參數而無須預先通知 / The above specifications can be altered without prior notice

項目	Items	Unit	I-MACH 50												
鎖模部份 CLAMPING UNIT	鎖模力	Mould Locking Force	kN	500											
	開模力 (高壓)	Mould Unlocking Force	kN	56.1											
	移模力 (鎖模)	Mould Close Force	kN	29.1											
	移模力 (開模)	Mould Open Traverse Force	kN	27											
	最大鎖模行程	Max. Mould Open Stroke	mm	425											
	最小容模厚度	Min. Mould Height	mm	200											
	最大容模厚度	Max. Mould Height	mm	N/A											
	模板最大開距	Max. Daylight	mm	625											
	四柱內距 (水平 x 垂直)	Space Between Tie-bars (HxV)	mm	370 x 370											
	模板尺寸	Platen Size (HxV)	mm	570 x 570											
	哥林柱直徑	Diameter of Tie-bars	mm	50											
	頂針力	Ejector Force, Forward/Retract	kN	34.6/23/7											
	最大頂針行程	Max. Ejector Stroke	mm	150											
	最大移模速度, 開模 / 鎖模	Max. Velocity (Open/Close)	mm/sec	760/707											
	最大模具重量	Max. Mould Weight - Total/Moving platen	kg	580/380											
注射部份 INJECTION UNIT	射台型號	Injection Unit		ST180			ST245			ST330					
	螺桿直徑	Screw Diameter	mm	25	28	32	28	32	36	32	36	40			
	理論注射容積	Swept Volume	c.c	61	77	101	86	112	142	128	162	201			
	注射重量 (PS)	Shot Weight (PS)	g	55	70	91	78	102	129	117	148	182			
	注射壓力	Specific Injection Pressure	bar	3087	2460	1884	2952	2260	1785	2670	2109	1708			
	高注射率	Injection Rate	c.c/sec	83	104	136	86	113	143	96	121	150			
	注射速度	Injection Velocity	mm/sec	169			141			119					
	塑化能力 (PS)	Plasticizing Capacity (PS)	g/sec	12.2	16	23.3	12.4	18	25.6	12.9	18.3	23.8			
	螺桿長徑比	Screw L:D Ratio	L/D	22.4	20	17.8	22.8	20	17.7	22.5	20	18			
	注射行程	Screw Stroke	mm	125			140			160					
	螺桿轉距	Screw Torque	Nm	403			503			727					
	螺桿轉速	Screw Speed	r.p.m.	10-522			10-418			10-278					
射咀接觸力	Nozzle Sealing Force	kN	37.6			37.6			42.84						
射咀行程	Nozzle Retract Stroke	mm	220			220			220						
電熱功率	Heating Capacity of Barrel	kW	4.5			5.5			6.55						
加熱區的數量	Number of Heating Zones & Barrel	qty	4 + N			4 + N			4 + N						
其他 OTHERS	油泵電機功率	Rated Power of Pump Drive Servo Motor	kW	14											
	油箱容積	Oil Filling	l	220											
	液壓系統壓力	Hydraulic System Pressure	bar	175											
	機器重量	Machine Weight, Dry	Tons	2.4			2.4			2.9					
	外形尺寸 (LxWxH)	Machine Dimensions (LxWxH)	m	3.3x1.36x1.94			3.6x1.36x1.94			3.7x1.36x1.94					
	幹循環時間	Dry Cycle Time (EUROMAP 6)	mm-sec	298-1.5											
	國際尺寸評級	International Size Rating (EUROMAP)	ref	500H-189			500H-254			500H-343					

 模板尺寸
Platen Dimension

 落料口尺寸
Feeding Hole Dimension

 機械手安裝孔尺寸
Extractor Assembling Hole Dimension

• 最小模具尺寸 (mm) 為 230x230 / Smallest tolerable mould dimension: 230x230 (mm)

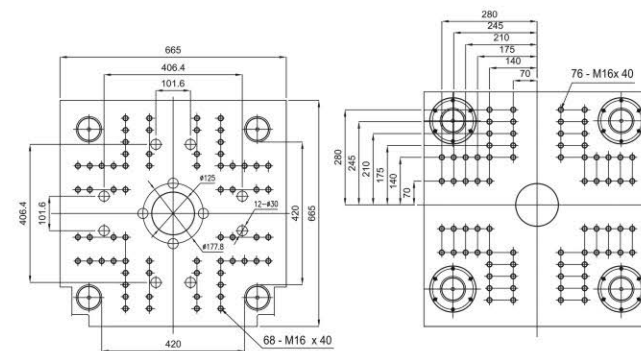
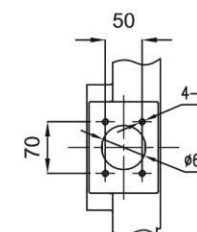
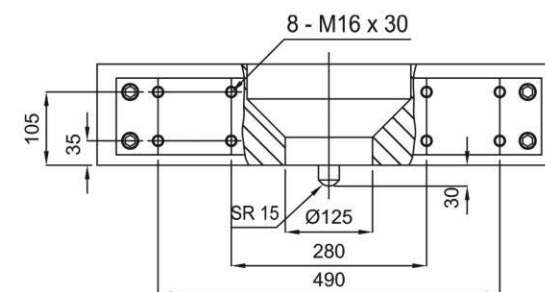
• 本公司可以隨時修改以上技術參數而無須預先通知 / The above specifications can be altered without prior notice

項目	Items	Unit	I-MACH 80									
鎖模部份 CLAMPING UNIT	鎖模力	Mould Locking Force	kN	800								
	開模力 (高壓)	Mould Unlocking Force	kN	69.3								
	移模力 (鎖模)	Mould Close Force	kN	37.4								
	移模力 (開模)	Mould Open Traverse Force	kN	31.8								
	最大鎖模行程	Max. Mould Open Stroke	mm	525								
	最小容模厚度	Min. Mould Height	mm	250								
	最大容模厚度	Max. Mould Height	mm	N/A								
	模板最大開距	Max. Daylight	mm	775								
	四柱內距 (水平 x 垂直)	Space Between Tie-bars (HxV)	mm	420 x 420								
	模板尺寸	Platen Size (HxV)	mm	665 x 665								
	哥林柱直徑	Diameter of Tie-bars	mm	65								
	頂針力	Ejector Force, Forward/Retract	kN	34.6/23.7								
	最大頂針行程	Max. Ejector Stroke	mm	150								
	最大移模速度, 開模 / 鎖模	Max. Velocity (Open/Close)	mm/sec	690/811								
最大模具重量	Max. Mould Weight - Total/Moving platen	kg	700/450									
注射部份 INJECTION UNIT	射台型號	Injection Unit		ST245			ST330			ST470		
	螺杆直徑	Screw Diameter	mm	28	32	36	32	36	40	36	40	45
	理論注射容積	Swept Volume	c.c	86	112	142	128	162	201	183	226	286
	注射重量 (PS)	Shot Weight (PS)	g	78	102	129	117	148	182	166	205	260
	注射壓力	Specific Injection Pressure	bar	2952	2260	1785	2670	2109	1708	2646	2143	1693
	高注射率	Injection Rate	c.c./sec	86	113	143	96	121	150	88	119	151
	注射速度	Injection Velocity	mm/sec	141			119			95		
	塑化能力 (PS)	Plasticizing Capacity (PS)	g/sec	12.4	18	25.6	12.9	18.3	23.8	13.9	18.1	24.9
	螺杆長徑比	Screw L:D Ratio	L/D	22.8	20	17.7	22.5	20	18	22.22	20	17.77
	注射行程	Screw Stroke	mm	140			160			180		
	螺桿轉距	Screw Torque	Nm	503			727			956		
其他 OTHERS	螺桿轉速	Screw Speed	r.p.m.	10-418			10-278			10-209		
	射咀接觸力	Nozzle Sealing Force	kN	37.71			43.1			43.1		
	射咀行程	Nozzle Retract Stroke	mm	220			250			250		
	電熱功率	Heating Capacity of Barrel	kW	5.5			6.55			8.25		
	加熱區的數量	Number of Heating Zones & Barrel	qty	4+ N			4 + N			4 + N		
油泵電機功率	Rated Power of Pump Drive Servo Motor	kW	14									
油箱容積	Oil Filling	l	220									
液壓系統壓力	Hydraulic System Pressure	bar	175									
機器重量	Machine Weight, Dry	Tons	3.4			3.7			3.8			
外形尺寸 (LxWxH)	Machine Dimensions (LxWxH)	m	3.75x1.47x1.99			3.9x1.47x1.99			4.15x1.47x1.99			
幹循環時間	Dry Cycle Time (EUROMAP 6)	mm-sec	367-1.7									
國際尺寸評級	International Size Rating (EUROMAP)	ref	800H-254			800H-343			800H-486			

 模板尺寸
Platen Dimension

 落料口尺寸
Feeding Hole Dimension

 機械手安裝孔尺寸
Extractor Assembling Hole Dimension

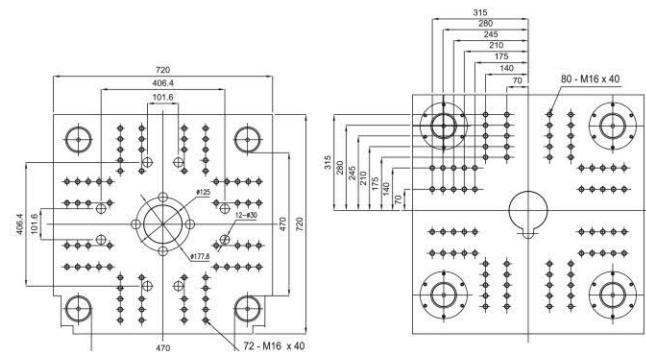
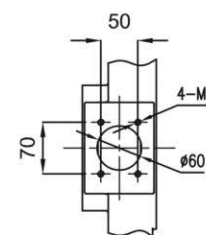
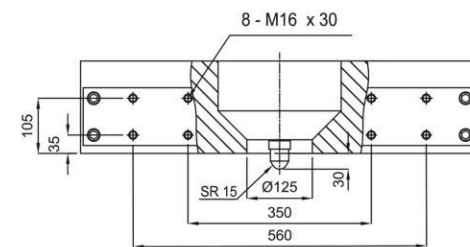
• 最小模具尺寸 (mm) 為 285x285 / Smallest tolerable mould dimension: 285x285 (mm)
 • 本公司可以隨時修改以上技術參數而無須預先通知 / The above specifications can be altered without prior notice

項目	Items	Unit	I-MACH 110										
			ST330	ST470	ST640								
鎖模部份 CLAMPING UNIT	鎖模力	Mould Locking Force	1100										
	開模力 (高壓)	Mould Unlocking Force	83.8										
	移模力 (鎖模)	Mould Close Force	42.9										
	移模力 (開模)	Mould Open Traverse Force	40.9										
	最大鎖模行程	Max. Mould Open Stroke	625										
	最小容模厚度	Min. Mould Height	250										
	最大容模厚度	Max. Mould Height	N/A										
	模板最大開距	Max. Daylight	875										
	四柱內距 (水平 x 垂直)	Space Between Tie-bars (HxV)	470 x 470										
	模板尺寸	Platen Size (HxV)	720 x 720										
	哥林柱直徑	Diameter of Tie-bars	75										
	頂針力	Ejector Force, Forward/Retract	34.6/23.7										
	最大頂針行程	Max. Ejector Stroke	150										
	最大移模速度, 開模 / 鎖模	Max. Velocity (Open/Close)	781/752										
	最大模具重量	Max. Mould Weight – Total/Moving platen	1100/730										
	注射部份 INJECTION UNIT	射台型號	Injection Unit	ST330			ST470			ST640			
		螺桿直徑	Screw Diameter	mm	32	36	40	36	40	45	40	45	50
		理論注射容積	Swept Volume	c.c	128	162	201	183	226	286	251	318	392
		注射重量 (PS)	Shot Weight (PS)	g	117	148	182	166	205	260	228	289	357
注射壓力		Specific Injection Pressure	bar	2670	2109	1708	2646	2143	1693	2076	1681		
高注射率		Injection Rate	c.c/sec	120	152	187	121	149	189	122	154	190	
注射速度		Injection Velocity	mm/sec	160			119			97			
塑化能力 (PS)		Plasticizing Capacity (PS)	g/sec	16.1	22.9	29.9	17.4	22.7	31.2	19.1	26.3	33.5	
螺桿長徑比		Screw L:D Ratio	L/D	22.5	20	18	22.22	20	17.77	22.5	20	18	
注射行程		Screw Stroke	mm	160			180			200			
螺桿轉距		Screw Torque	Nm	727			956			1137			
螺桿轉速		Screw Speed	r.p.m.	10-348			10-261			10-232			
其他 OTHERS		射咀接觸力	Nozzle Sealing Force	kN	43.1			43.1			57.42		
	射咀行程	Nozzle Retract Stroke	mm	250			250			320			
	電熱功率	Heating Capacity of Barrel	kW	6.55			8.25			10.4			
	加熱區的數量	Number of Heating Zones & Barrel	qty	4 + N			4 + N			4 + N			
	油泵電機功率	Rated Power of Pump Drive Servo Motor	kW				18						
	油箱容積	Oil Filling	l				275						
	液壓系統壓力	Hydraulic System Pressure	bar				175						
機器重量	Machine Weight, Dry	Tons	4.7			4.8			4.9				
外形尺寸 (LxWxH)	Machine Dimensions (LxWxH)	m	3.95x1.61x1.92			4.1x1.61x1.92			4.35x1.61x1.92				
幹循環時間	Dry Cycle Time (EUROMAP 6)	mm-sec				438-2.0							
國際尺寸評級	International Size Rating (EUROMAP)	ref	1100H-343			1100H-486			1100H-486				

 模板尺寸
Platen Dimension

 落料口尺寸
Feeding Hole Dimension

 機械手安裝孔尺寸
Extractor Assembling Hole Dimension

• 最小模具尺寸 (mm) 為 330x330 / Smallest tolerable mould dimension: 330x330 (mm)

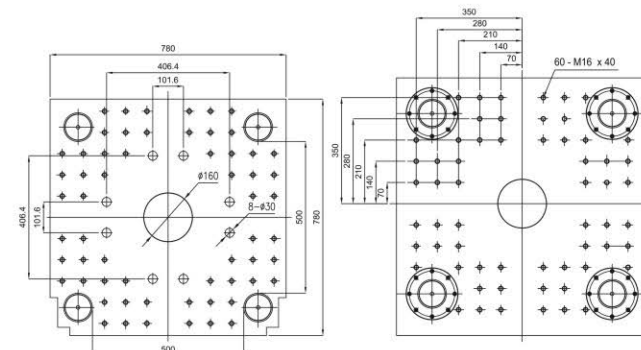
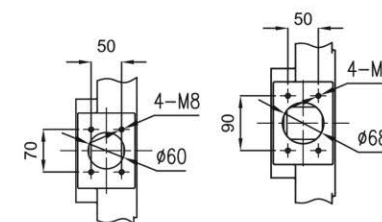
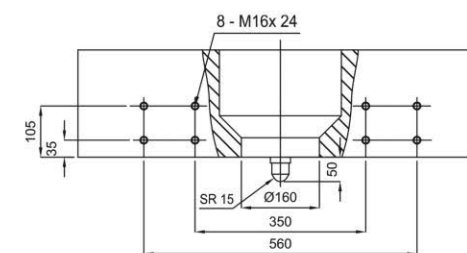
• 本公司可以隨時修改以上技術參數而無須預先通知 / The above specifications can be altered without prior notice

項目	Items	Unit	I-MACH 150											
			ST470			ST640			ST920					
鎖模部份 CLAMPING UNIT	鎖模力	Mould Locking Force	1500											
	開模力 (高壓)	Mould Unlocking Force	99.8											
	移模力 (鎖模)	Mould Close Force	48.5											
	移模力 (開模)	Mould Open Traverse Force	51.3											
	最大鎖模行程	Max. Mould Open Stroke	675											
	最小容模厚度	Min. Mould Height	300											
	最大容模厚度	Max. Mould Height	N/A											
	模板最大開距	Max. Daylight	975											
	四柱內距 (水平 x 垂直)	Space Between Tie-bars (HxV)	500 x 500											
	模板尺寸	Platen Size (HxV)	780 x 780											
	哥林柱直徑	Diameter of Tie-bars	85											
	頂針力	Ejector Force, Forward/Retract	88.7/45.2											
	最大頂針行程	Max. Ejector Stroke	200											
	最大移模速度, 開模 / 鎖模	Max. Velocity (Open/Close)	794/839											
最大模具重量	Max. Mould Weight - Total/Moving platen	1700/1150												
注射部份 INJECTION UNIT	射台型號	Injection Unit	ST470			ST640			ST920					
	螺杆直徑	Screw Diameter	mm	36	40	45	40	45	50	45	50	55		
	理論注射容積	Swept Volume	c.c	183	226	286	251	318	392	357	441	534		
	注射重量 (PS)	Shot Weight (PS)	g	166	205	260	228	289	357	325	402	486		
	注射壓力	Specific Injection Pressure	bar	2646		1693	2627	2076	1681	2646	2143	1771		
	高注射率	Injection Rate	c.c/sec	152	188	238	153	194	240	152	188	228		
	注射速度	Injection Velocity	mm/sec	150			122			96				
	塑化能力 (PS)	Plasticizing Capacity (PS)	g/sec	22.7	29.5	40.6	24.8	34.1	43.5	25.9	33	43		
	螺杆長徑比	Screw L:D Ratio	L/D	22.22	20	17.77	22.5	20	18	22.33	20	18.18		
	注射行程	Screw Stroke	mm	180			200			225				
	螺桿轉距	Screw Torque	Nm	956			1137			1495				
其他 OTHERS	螺桿轉速	Screw Speed	r.p.m.	10-329			10-292			10-219				
	射咀接觸力	Nozzle Sealing Force	kN	43.1			57.24			56.7				
	射咀行程	Nozzle Retract Stroke	mm	250			320			320				
	電熱功率	Heating Capacity of Barrel	kW	8.25			10.4			13				
	加熱區的數量	Number of Heating Zones & Barrel	qty	4+ N			4 + N			4 + N				
油泵電機功率	Rated Power of Pump Drive Servo Motor	kW	23											
油箱容積	Oil Filling	l	350											
液壓系統壓力	Hydraulic System Pressure	bar	175											
機器重量	Machine Weight, Dry	Tons	6.8			6.9			7.0					
外形尺寸 (LxWxH)	Machine Dimensions (LxWxH)	m	4.55x1.59x2.14			4.8x1.59x2.14			5.04x1.59x2.14					
幹循環時間	Dry Cycle Time (EUROMAP 6)	mm-sec	473-2.2											
國際尺寸評級	International Size Rating (EUROMAP)	ref	1500H-486			1500H-660			1500H-947					

 模板尺寸
Platen Dimension

 落料口尺寸
Feeding Hole Dimension

 機械手安裝孔尺寸
Extractor Assembling Hole Dimension

• 最小模具尺寸 (mm) 為 330x330 / Smallest tolerable mould dimension: 330x330 (mm)
 • 本公司可以隨時修改以上技術參數而無須預先通知 / The above specifications can be altered without prior notice

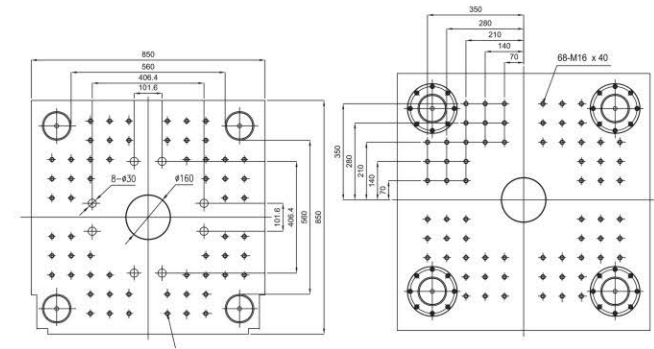
項目	Items	Unit	I-MACH 180									
			ST640			ST920			ST1200			
鎖模部份 CLAMPING UNIT	鎖模力	Mould Locking Force	1800									
	開模力 (高壓)	Mould Unlocking Force	117.1									
	移模力 (鎖模)	Mould Close Force	54									
	移模力 (開模)	Mould Open Traverse Force	63									
	最大鎖模行程	Max. Mould Open Stroke	725									
	最小容模厚度	Min. Mould Height	300									
	最大容模厚度	Max. Mould Height	N/A									
	模板最大開距	Max. Daylight	1025									
	四柱內距 (水平 x 垂直)	Space Between Tie-bars (HxV)	560 x 560									
	模板尺寸	Platen Size (HxV)	850 x 850									
	哥林柱直徑	Diameter of Tie-bars	95									
	頂針力	Ejector Force, Forward/Retract	88.7/45.2									
	最大頂針行程	Max. Ejector Stroke	200									
	最大移模速度, 開模 / 鎖模	Max. Velocity (Open/Close)	668/753									
	最大模具重量	Max. Mould Weight - Total/Moving platen	2500/1700									
	注射部份 INJECTION UNIT	射台型號	Injection Unit									
		螺桿直徑	Screw Diameter	40	45	50	45	50	55	50	55	60
		理論注射容積	Swept Volume	251	318	392	357	441	534	490	593	706
注射重量 (PS)		Shot Weight (PS)	228	289	357	325	402	486	446	540	643	
注射壓力		Specific Injection Pressure	2627	2076	1681	2646	2143	1771	2527	2088	1754	
高注射率		Injection Rate	153	194	240	152	188	228	159	193	230	
注射速度		Injection Velocity	122			96			81			
塑化能力 (PS)		Plasticizing Capacity (PS)	24.8	34.1	43.5	25.9	33	43	26	33.9	43.2	
螺桿長徑比		Screw L:D Ratio	22.5	20	18		20	18.18	22	20	18.33	
注射行程		Screw Stroke	200			225			250			
螺桿轉距		Screw Torque	1137			1495			1897			
螺桿轉速		Screw Speed	10-292			10-219			10-175			
射咀接觸力		Nozzle Sealing Force	57.24			57.24			79.71			
射咀行程	Nozzle Retract Stroke	320			320			320				
電熱功率	Heating Capacity of Barrel	10.4			13			15.6				
加熱區的數量	Number of Heating Zones & Barrel	4 + N			4 + N			4 + N				
其他 OTHERS	油泵電機功率	Rated Power of Pump Drive Servo Motor	23									
	油箱容積	Oil Filling	350									
	液壓系統壓力	Hydraulic System Pressure	175									
	機器重量	Machine Weight, Dry	8.4			8.3			8.8			
	外形尺寸 (LxWxH)	Machine Dimensions (LxWxH)	4.92x1.75x2.19			5.16x1.75x2.19			5.43x1.75x2.19			
	幹循環時間	Dry Cycle Time (EUROMAP 6)	508-2.4									
	國際尺寸評級	International Size Rating (EUROMAP)	1800H-660			1800H-947			1800H-1240			

模板尺寸
Platen Dimension



落料口尺寸
Feeding Hole Dimension

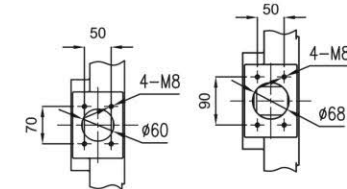

機械手安裝孔尺寸
Extractor Assembling Hole Dimension

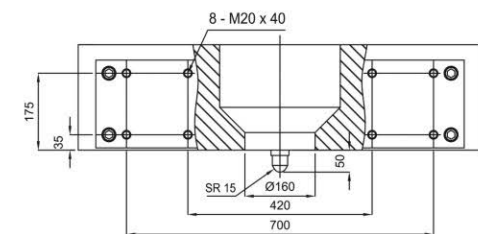

• 最小模具尺寸 (mm) 為 390x390 / Smallest tolerable mould dimension: 390x390 (mm)

• 本公司可以隨時修改以上技術參數而無須預先通知 / The above specifications can be altered without prior notice

項目	Items	Unit	I-MACH 230											
鎖模部份 CLAMPING UNIT	鎖模力	Mould Locking Force	kN	2300										
	開模力 (高壓)	Mould Unlocking Force	kN	135.8										
	移模力 (鎖模)	Mould Close Force	kN	56.8										
	移模力 (開模)	Mould Open Traverse Force	kN	79										
	最大鎖模行程	Max. Mould Open Stroke	mm	825										
	最小容模厚度	Min. Mould Height	mm	300										
	最大容模厚度	Max. Mould Height	mm	N/A										
	模板最大開距	Max. Daylight	mm	1125										
	四柱內距 (水平 x 垂直)	Space Between Tie-bars (HxV)	mm	600 x 600										
	模板尺寸	Platen Size (HxV)	mm	870 x 870										
	哥林柱直徑	Diameter of Tie-bars	mm	100										
	頂針力	Ejector Force, Forward/Retract	kN	88.7/45.2										
	最大頂針行程	Max. Ejector Stroke	mm	200										
	最大移模速度, 開模 / 鎖模	Max. Velocity (Open/Close)	mm/sec	655/910										
最大模具重量	Max. Mould Weight - Total/Moving platen	kg	3300/2200											
注射部份 INJECTION UNIT	射台型號	Injection Unit		ST920			ST1200			ST1540				
	螺杆直徑	Screw Diameter	mm	45	50	55	50	55	60	55	60	65		
	理論注射容積	Swept Volume	c.c	357	441	534	490	593	706	653	777	912		
	注射重量 (PS)	Shot Weight (PS)	g	325	402	486	446	540	643	594	707	830		
	注射壓力	Specific Injection Pressure	bar	2646	2143	1771	2527	2088	1754		2042	1740		
	高注射率	Injection Rate	c.c/sec	193	238	283	203	245	292	211	251	294		
	注射速度	Injection Velocity	mm/sec	121			103			88				
	塑化能力 (PS)	Plasticizing Capacity (PS)	g/sec	31.9	40.6	52.9	32.1	41.8	53.4	32.1	40.9	51.3		
	螺杆長徑比	Screw L:D Ratio	L/D	22.33	20	18.18	22	20	18.33	21.81	20	18.46		
	注射行程	Screw Stroke	mm	225			250			275				
	螺桿轉距	Screw Torque	Nm	1495			1897			2469				
	螺桿轉速	Screw Speed	r.p.m.	10-278			10-222			10-167				
	射咀接觸力	Nozzle Sealing Force	kN	57.24			80.81			79.71				
	射咀行程	Nozzle Retract Stroke	mm	380			450			450				
電熱功率	Heating Capacity of Barrel	kW	13			15.6			18.7					
加熱區的數量	Number of Heating Zones & Barrel	qty	4+ N			4 + N			4 + N					
其他 OTHERS	油泵電機功率	Rated Power of Pump Drive Servo Motor	kW	31										
	油箱容積	Oil Filling	l	440										
	液壓系統壓力	Hydraulic System Pressure	bar	175										
	機器重量	Machine Weight, Dry	Tons	9.7			10.2			10.3				
	外形尺寸 (LxWxH)	Machine Dimensions (LxWxH)	m	5.33x1.95x2.19			5.58x1.95x2.19			5.7x1.95x2.19				
	幹循環時間	Dry Cycle Time (EUROMAP 6)	mm-sec	577-2.6										
國際尺寸評級	International Size Rating (EUROMAP)	ref	2300H-947			2300H-1240			2300H-1588					

模板尺寸
Platen Dimension

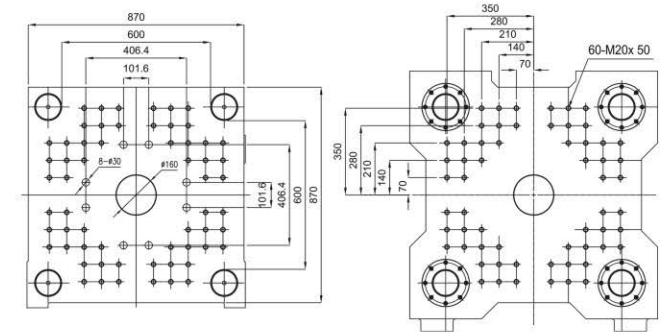

落料口尺寸
Feeding Hole Dimension

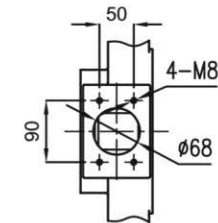

機械手安裝孔尺寸
Extractor Assembling Hole Dimension

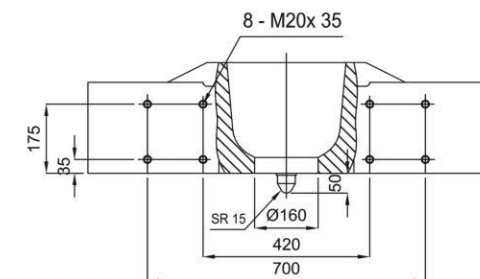

• 最小模具尺寸 (mm) 為 440x440 / Smallest tolerable mould dimension: 440x440 (mm)
 • 本公司可以隨時修改以上技術參數而無須預先通知 / The above specifications can be altered without prior notice

項目	Items	Unit	I-MACH 280											
鎖模部份 CLAMPING UNIT	鎖模力	Mould Locking Force	kN	2800										
	開模力 (高壓)	Mould Unlocking Force	kN	155.96										
	移模力 (鎖模)	Mould Close Force	kN	65.19										
	移模力 (開模)	Mould Open Traverse Force	kN	90.8										
	最大鎖模行程	Max. Mould Open Stroke	mm	925										
	最小容模厚度	Min. Mould Height	mm	300										
	最大容模厚度	Max. Mould Height	mm	N/A										
	模板最大開距	Max. Daylight	mm	1225										
	四柱內距 (水平 x 垂直)	Space Between Tie-bars (HxV)	mm	635 x 635										
	模板尺寸	Platen Size (HxV)	mm	950 x 950										
	哥林柱直徑	Diameter of Tie-bars	mm	115										
	頂針力	Ejector Force, Forward/Retract	kN	88.7/45.2										
	最大頂針行程	Max. Ejector Stroke	mm	200										
	最大移模速度, 開模 / 鎖模	Max. Velocity (Open/Close)	mm/sec	712/993										
	最大模具重量	Max. Mould Weight - Total/Moving platen	kg	4000/3000										
注射部份 INJECTION UNIT	射台型號	Injection Unit		ST1200			ST1540			ST1940				
	螺桿直徑	Screw Diameter	mm	50	55	60	55	60	65	60	65	70		
	理論注射容積	Swept Volume	c.c	490	593	706	653	777	912	848	995	1154		
	注射重量 (PS)	Shot Weight (PS)	g	446	540	643	594	707	830	771	905	1050		
	注射壓力	Specific Injection Pressure	bar	2527	2088	1754	2431	2042	1740	2352	2004	1995		
	高注射率	Injection Rate	c.c/sec	253	307	35	263	314	368	272	320	371		
	注射速度	Injection Velocity	mm/sec	129			111			96				
	塑化能力 (PS)	Plasticizing Capacity (PS)	g/sec	40	52.2	66.5	40.1	51.1	64	45.4	56.9	65.9		
	螺桿長徑比	Screw L:D Ratio	L/D	22	20	18.33	21.81	20	18.46	21.66	20	1857		
	注射行程	Screw Stroke	mm	250			275			300				
	螺桿轉距	Screw Torque	Nm	1897			2469			2778				
	螺桿轉速	Screw Speed	r.p.m.	10-278			10-209			10-190				
	射咀接觸力	Nozzle Sealing Force	kN	80.81			80.81			93.1				
	射咀行程	Nozzle Retract Stroke	mm	450			450			480				
	電熱功率	Heating Capacity of Barrel	kW	15.6			18.7			21.5				
加熱區的數量	Number of Heating Zones & Barrel	qty	4 + N			4 + N			4 + N					
其他 OTHERS	油泵電機功率	Rated Power of Pump Drive Servo Motor	kW	39.4										
	油箱容積	Oil Filling	l	550										
	液壓系統壓力	Hydraulic System Pressure	bar	175										
	機器重量	Machine Weight, Dry	Tons	11.4			11.5			11.7				
	外形尺寸 (LxWxH)	Machine Dimensions (LxWxH)	m	5.8x2.04x2.34			5.9x2.04x2.34			6.13x2.04x2.34				
	幹循環時間	Dry Cycle Time (EUOMAP 6)	mm-sec	648-2.9										
	國際尺寸評級	International Size Rating (EUOMAP)	ref	2800H-1240			2800H-1588			2800H-1995				

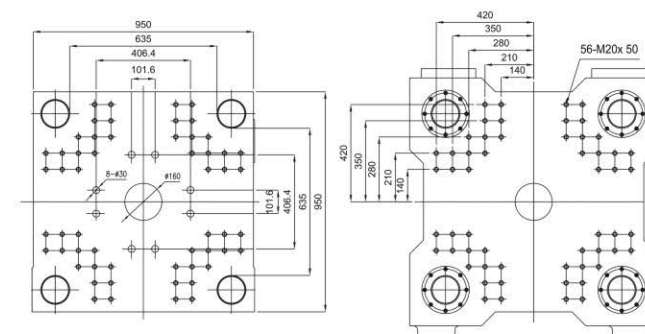
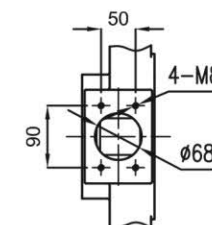
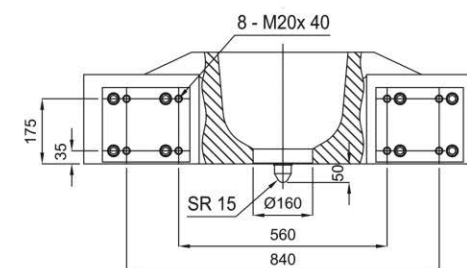
 模板尺寸
Platen Dimension

 落料口尺寸
Feeding Hole Dimension

 機械手安裝孔尺寸
Extractor Assembling Hole Dimension

• 最小模具尺寸 (mm) 為 450x450 / Smallest tolerable mould dimension: 450x450 (mm)

• 本公司可以隨時修改以上技術參數而無須預先通知 / The above specifications can be altered without prior notice

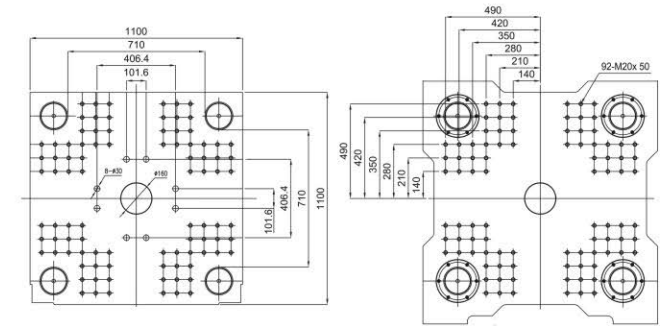
	項目	Items	Unit	I-MACH 350											
鎖模部份 CLAMPING UNIT	鎖模力	Mould Locking Force	kN	3500											
	開模力 (高壓)	Mould Unlocking Force	kN	224.59											
	移模力 (鎖模)	Mould Close Force	kN	120.94											
	移模力 (開模)	Mould Open Traverse Force	kN	90.8											
	最大鎖模行程	Max. Mould Open Stroke	mm	1025											
	最小容模厚度	Min. Mould Height	mm	300											
	最大容模厚度	Max. Mould Height	mm	N/A											
	模板最大開距	Max. Daylight	mm	1375											
	四柱內距 (水平 x 垂直)	Space Between Tie-bars (HxV)	mm	710 x 710											
	模板尺寸	Platen Size (HxV)	mm	1100 x 1100											
	哥林柱直徑	Diameter of Tie-bars	mm	130											
	頂針力	Ejector Force, Forward/Retract	kN	88.7/45.2											
	最大頂針行程	Max. Ejector Stroke	mm	250											
	最大移模速度, 開模 / 鎖模	Max. Velocity (Open/Close)	mm/sec	786/674											
最大模具重量	Max. Mould Weight - Total/Moving platen	kg	5100/3400												
注射部份 INJECTION UNIT	射台型號	Injection Unit		ST1540			ST1940			ST2500					
	螺杆直徑	Screw Diameter	mm	55	60	65	60	65	70	65	70	75			
	理論注射容積	Swept Volume	c.c	653	777	912	848	995	1154	1078	1250	1435			
	注射重量 (PS)	Shot Weight (PS)	g	594	707	830	771	905	1050	981	1138	1306			
	注射壓力	Specific Injection Pressure	bar	2431	2042	1740	2352	2004	1728	2385	2057	1792			
	高注射率	Injection Rate	c.c/sec	332	393	464	343	403	467	338	393	451			
	注射速度	Injection Velocity	mm/sec	139			121			102					
	塑化能力 (PS)	Plasticizing Capacity (PS)	g/sec	50.2	64	80.2	56.8	71.1	82.5	58.1	67.4	82.2			
	螺杆長徑比	Screw L:D Ratio	L/D	22.81	20	18.46	21.66	20	18.57	21.53	20	1866			
	注射行程	Screw Stroke	mm	275			300			325					
	螺桿轉距	Screw Torque	Nm	2469			2778			3990					
	螺桿轉速	Screw Speed	r.p.m.	10~263			10~239			10~180					
	射咀接觸力	Nozzle Sealing Force	kN	79.71			91.66			91.66					
	射咀行程	Nozzle Retract Stroke	mm	450			450			450					
電熱功率	Heating Capacity of Barrel	kW	18.7			21.5			23.10						
加熱區的數量	Number of Heating Zones & Barrel	qty	4+ N			4 + N			4 + N						
其他 OTHERS	油泵電機功率	Rated Power of Pump Drive Servo Motor	kW	45											
	油箱容積	Oil Filling	l	700											
	液壓系統壓力	Hydraulic System Pressure	bar	175											
	機器重量	Machine Weight, Dry	Tons	14.4			14.6			14.9					
	外形尺寸 (LxWxH)	Machine Dimensions (LxWxH)	m	6.2x2.25x2.39			6.43x2.25x2.39			6.75x2.25x2.39					
	幹循環時間	Dry Cycle Time (EUROMAP 6)	mm-sec	718~3.2											
	國際尺寸評級	International Size Rating (EUROMAP)	ref	3500H-1588			3500H-1995			3500H-2572					

模板尺寸
Platen Dimension



落料口尺寸
Feeding Hole Dimension

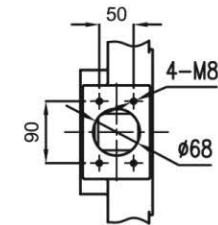

機械手安裝孔尺寸
Extractor Assembling Hole Dimension

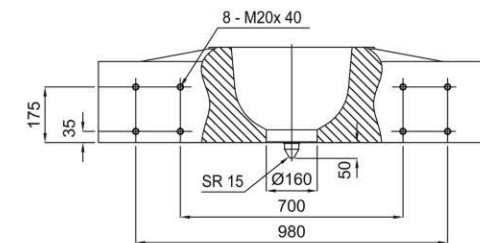

• 最小模具尺寸 (mm) 為 600x600 / Smallest tolerable mould dimension: 600x600 (mm)
 • 本公司可以隨時修改以上技術參數而無須預先通知 / The above specifications can be altered without prior notice

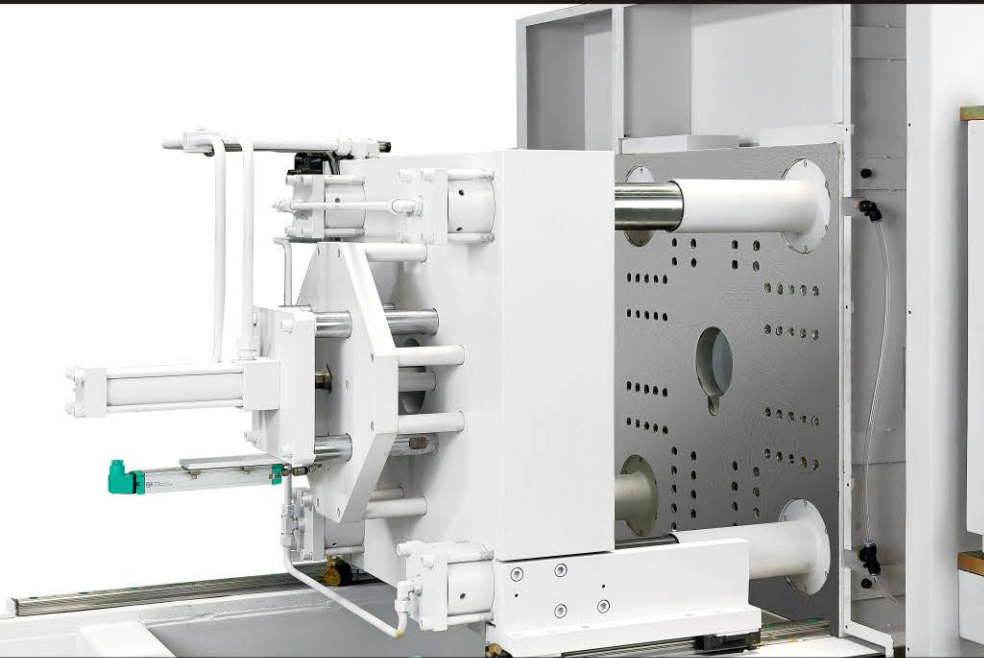

Standard Features

- Two-platen locking unit with a locking cylinder on each tie bar giving a guaranteed locking force
- High tensile steel tie bars, hard chrome plated
- Platens prepared to "EUROMAP 2"
- Multiple ejection points as "EUROMAP 2"
- Lubrication free operation
- Robot mounting interface as "EUROMAP 18"
- Robot control interface as "EUROMAP 67"
- One channel of core pulling on moving platen electrically as "EUROMAP 13"
- One channel of core pulling on fixed platen electrically as "EUROMAP 13"
- One channel of air blast on moving platen
- One channel of air blast on fixed platen
- Mould cooling water flow meter, 4 tube
- Isolation of mould cooling water if any alarm set to stop the machine
- Extended linear bearings under moving platen to ensure platens remain parallel
- Automatic die height adjustment system
- Electrically monitored safety valve in mould close hydraulic system as EN201
- Guarding of locking unit as "EUROPEAN MACHINE DIRECTIVE"
- Photo-electric detection of ejected moulding
- Cantilevered locking unit for freedom of choice for positioning peripheral equipment

標準裝置

- 兩板鎖模結構，每條哥林柱帶有鎖模油缸，可確保鎖模力
- 高抗拉表面鍍硬鉻哥林柱• 模板滿足“EUROMAP 2”
- 多點頂針滿足“EUROMAP 2”
- 無需潤滑運作
- 機械手安裝接口滿足“EUROMAP 18”
- 機械手控制接口滿足“EUROMAP 67”
- 動模抽芯 1 組，電器控制接口滿足"EUROMAP 13"
- 定模抽芯 1 組，電器控制接口滿足"EUROMAP 13"
- 動模一組吹風
- 定模一組吹風
- 4 管模溫冷卻水流量計
- 在出現警報和停機模溫冷卻工作
- 動模板下裝直線導軌確保模板平行運行
- 自動調模裝置
- 符合 EN201 裝備電子監控安全閥
- 鎖模單元防護滿足歐洲機械指令標準
- 光電開關產品頂出檢測
- 懸空的鎖模機架結構給外設提供了足夠的安裝選擇空間



Optional Features

- T-Slotted platens, EUROMAP 2, in lieu of standard tapped holes for mould mounting
- Platens prepared to SPI standard in lieu of EUROMAP
- One additional core pulling system with connections on moving platen, means total = 2/platen
- One additional core pulling system with connections on fixed platen, means total = 2/platen
- One additional air blast system with connections on moving platen, means total = 2/platen
- One additional air blast system with connections on fixed platen, means total = 2/platen
- Extended mould height/open stroke
- Additional channels on mould cooling water flow meter
- Unscrewing device, hydraulic, in lieu of ejector
- Electrically powered operators safety gate, "I-MACH 180" and above

可選裝置

- T 型槽模板，滿足 "EUROMAP 2"
- 模板採用 SPI 標準
- 動模板加多一組抽芯，共 2 組
- 定模板加多一組抽芯，共 2 組
- 動模板加多一組吹風，共 2 組
- 定模板加多一組吹風，共 2 組
- 加大容量及開模行程
- 附加多組模溫冷卻水流量計
- 增加液壓旋脫裝置
- "I-MACH 180" 及以上配電動安全門



Standard Features

- Open nozzle, spherical seating
- Customer's choice of any one of three different injection units
- Customer's choice of any one of three screw diameters per injection unit
- Nitrided barrel and hard chrome plated screw assembly
- Universal screw, no-mixing, with three piece screw tip also non-mixing
- Mica heater bands for barrel
- Balanced double carriage cylinders for deflection free connection of nozzle
- Stainless steel hopper
- Temperature controlled hopper feed throat
- Perforated stainless steel guard over heater bands
- Screw drive by low speed, high torque, hydraulic motor
- Injection unit slides by linear ball bearings
- Swiveling injection unit, manual
- Sliding interlocked guard over the front of the injection unit for protection from purging

標準裝置

- 開放式球面射嘴
- 三款不同的注射單元可選
- 每款注射單元有三款螺桿備選
- 氮化炮筒和鍍硬鉻螺桿組件
- 通用不混色螺桿，螺桿三小件也不混色
- 炮筒用雲母加熱圈
- 平衡式雙射移油缸有效保證射嘴接觸點不偏斜
- 不銹鋼料斗
- 料斗落料口溫度控制
- 不鏽鋼炮筒護罩
- 熔膠採用低速大扭矩液壓馬達驅動
- 射座採用線性導軌
- 手動射座轉出功能（方便螺桿拆卸）
- 射座前端滑動互鎖防護罩，在清洗螺桿時提供保護

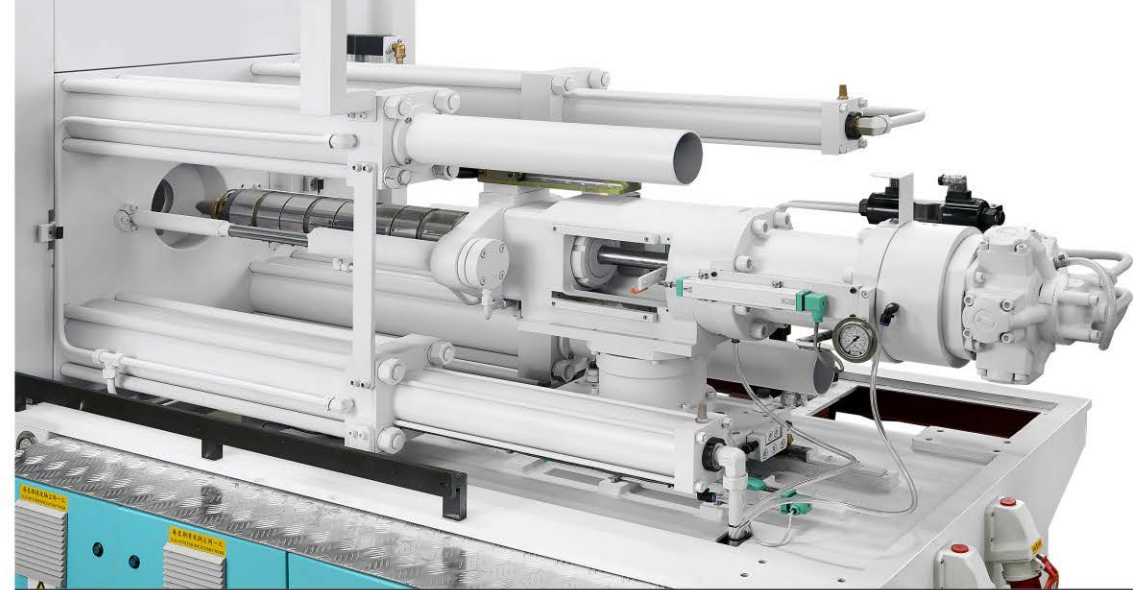

Optional Features

- Needle type shut-off nozzle operated by spring, ref TSN
- Needle type shut-off nozzle, hydraulically operated, ref HP
- Cross bolt type shut-off nozzle, pneumatically operated, ref BHP
- Bi-metallic barrel and screw assembly type A. 30-50% glass filled materials
- Bi-metallic barrel and screw assembly type B. 15-30% glass filled materials
- Bi-metallic barrel and screw assembly type C. 5-15% glass filled materials
- Barrier screw in lieu of standard universal screw
- Machine prepared for processing UPVC with high torque screw drive, special UPVC screw and cooling fans on the two heating zones nearest the nozzle
- Ceramic heater bands in lieu of standard mica type
- Increased torque screw drive motor
- Hopper magnet

可選裝置

- 由彈簧操作的針型關閉噴嘴，參考 TSN// 彈弓射嘴
- 針式關閉噴嘴，液壓操作，參考 HP// 液壓關閉射嘴
- 橫向螺栓式關閉噴嘴，氣動操作，參考 BHP// 氣動關閉射嘴
- A 型雙合金炮筒和螺桿組件：適於啤制含有 30-50% 玻璃纖維的材料
- B 型雙合金炮筒和螺桿組件：適於啤制含有 15-30% 玻璃纖維的材料
- C 型雙合金炮筒和螺桿組件：適於啤制含有 5-15% 玻璃纖維的材料
- 專用螺桿代替標準通用螺桿
- UPVC 專用機，配大扭矩熔膠馬達，專用 UPVC 螺桿，在靠近射嘴的兩個加熱區增加 2 組冷卻風扇。
- 陶瓷加熱殼代替標準發熱殼
- 加大熔膠馬達
- 料斗磁力架

I-MACH Hydraulic System / 液壓系統





Optional Features

- Proportional valve for ejector stroke control
- Offline filtration system for hydraulic oil

可選裝置

- 頂針控制採用比例閥
- 液壓油離線過濾系統



Standard Features

- One circuit breaker for machine and connected devices
- Control systems contained in sheet metal cabinets in front of the injection base
- Ventilation fans for forced draft cooling of control cabinets
- All electrical components of European origin or carry "CE" Mark
- On screen setting and display of mould close movement, 5 stages, with LP mould protection
- On screen setting and display of locking force
- On screen setting and display of carriage forward movement, 2 stages
- On screen setting and display of injection fill, 6 stages, stroke dependent
- On screen setting and display of injection hold, 6 stages, time dependent
- On screen setting and display of plasticizing, screw speed and back pressure, 5 stages
- On screen setting and display of melt decompression, two positions, before/after plasticizing
- On screen setting and display of carriage retract movement, 2 stages
- On screen setting and display of mould open movement, 5 stages
- On screen setting and display of ejector forward movement, 3 stages
- On screen setting and display of ejector retract movement
- On screen setting of ejector mode, single or multiple stroke, full set stroke or pulsed
- On screen setting and display of all variable process times
- On screen setting and display of all variable process temperatures
- Screen display of thermocouple failure
- Screen display of Kw.hr/kg
- Screen display of hydraulic oil level low alarm
- Screen display of oil over temperature alarm
- Screen display of oil filter clogged alarm
- Screen display of barrel over temperature alarm
- Screen display of mould obstructed alarm
- Screen display of robot malfunction alarm
- Screen display of "time over run" on any cycle phase
- Screen display of alarm log
- SPC programme
- Quantity control programme with selectable auto shut down
- Semi-automatic barrel purging programme
- Selectable barrel stand-by temperature
- Cold start protection for screw rotate
- Screen display of cycles run and hours run
- Change over from injection fill to injection hold by stroke, or time, or pressure
- Melt cushion control with output signal for 'out of cushion' cycles
- Heating calendar, 7 days x 24 hours
- External and internal mould data storage
- Selectable screen language, English + one other
- High resolution LVDT's for monitoring platen, ejector, screw and carriage strokes
- PID temperature control
- SSR switching of heater bands
- One single phase, 16A, socket outlet
- One three phase, 16A, socket outlet
- One three phase, 32A, socket outlet

標準裝置

- 一個機器本身和所連外部設備保護用的斷路器
- 控制系統置於射膠單元前下部鐵皮控制箱中
- 控制電箱採用軸流風扇冷卻
- 所有電器元件採用歐洲進口或是具有 "CE" 標誌的
- 鎖模動作 5 段控制，具有低壓護模功能
- 在屏幕上設置和顯示鎖定力
- 可設置和顯示兩段射座前進動作
- 可設置和顯示 6 段射膠動作
- 可設置和顯示 6 段保壓動作
- 可設置和顯示 5 段熔膠動作，包括螺桿轉速和背壓。
- 可設置和顯示鬆退動作。包括熔膠前 / 熔膠後鬆退動作。
- 可設置和顯示兩段射座後退動作。
- 可設置和顯示 5 段開模動作。
- 可設置和顯示 3 段頂針前進動作。
- 可設置和顯示頂針回退動作。
- 可設置頂針動作模式：單次；多次；振動
- 可設置和顯示所有變化的過程時間。
- 可設置和顯示所有變化的過程溫度。
- 屏幕顯示熱電偶故障
- 屏幕能夠顯示 Kw.hr/kg
- 液壓油油位低報警屏幕顯示功能
- 液壓油溫度過高報警 屏幕顯示功能
- 濾油器堵塞報警的屏幕顯示功能
- 料筒過溫報警屏幕顯示功能
- 模具阻塞報警屏幕顯示功能
- 機械手故障報警屏幕顯示功能
- 每一循環 " 運行超時 " 監測功能
- 報警日誌屏幕顯示功能
- SPC 統計過程控制功能
- 帶有可選擇生產量達到自動停機功能
- 半自動料筒清洗程序
- 可選擇的炮筒保溫溫度。
- 螺桿冷起動保護功能
- 屏幕上可顯示周期時間和運行時間。
- 射膠保壓方式：行程、時間及壓力可選
- 射前儲料功能。
- 可 7 天 24 小時預約加熱功能。
- 外部和內部模具數據存儲功能
- 可選擇的屏幕語言
- 採用高分辨率 LVDT 監測模板，頂針，螺桿和注射單元行程
- PID 溫度控制
- 採用 SSR 進行加熱控制
- 一個單相 16A 插座
- 一個三相 16A 插座
- 一個三相 32A 插座



Optional Features

- Screen display of maximum injection pressure
- Screen display of nozzle sealing force
- KEBA "EASY NET" remote monitoring system
- Upgrade to KEBA 2000 series controller in lieu of 1000 Series
- Hot runner temperature control with setting and display on KEBA screen and socket outlet to mould for thermocouples and power on rear edge of fixed platen, 16 zones maximum
- Sequential injection, ten stage, with hydraulic, or pneumatic, valve gates, 16 gates maximum
- Potential free relay contacts active during plasticizing
- Potential free relay contact for activating belt conveyor
- Additional socket outlets 16A, single phase
- Additional socket outlets 16A, three phase
- Additional socket outlets 32A, three phase

可選裝置

- 屏幕可顯示最大注射壓力
- 屏幕可顯示射嘴接觸力
- KEBA "EASY NET" 遠程監控系統
- 將 KEBA 1000 系統升級到 i2000
- 在 KEBA 屏幕和插座上設置和顯示熱流道溫度控制熱電偶模製出口，固定模板後緣上電，最多 16 個區域
- 10 段順序射膠控制，配液壓或是氣動閥，最多可到 16 段
- 熔膠過程給出一組輸出（繼電器型觸點）
- 履帶輸送機的起動控制輸出（繼電器型觸點）
- 額外插座 16A，單相 / 1 6A 單項插座
- 額外的插座 16A，三相 / 1 6A 三項插座
- 額外的插座 32A，三相 / 3 2A 三項插座

仁興機器廠有限公司 (香港總部)

地址: 香港九龍觀塘開源道62號駱駝漆大廈第2座5字樓A&B室

電話: 852-2389 1338 傳真: 852-2797 8661

郵箱: info@yanhing.com

仁興機械(佛山)有限公司 (佛山高明工廠)

地址: 廣東省佛山市高明區楊和鎮高明大道中人景路13號

電話: 0757-8880 3372 傳真: 0757-8880 3329

www.yanhing.com

www.prowin.com.hk

Yan Hing Engineering Works Ltd.

Add: Flat A & B, 5/F., Block 2, Camelpaint Buildings,
62 Hoi Yuen Road, Kwun Tong, Kowloon, Hong Kong.

Tel: 852-23891338 Fax: 852-27978661

E-mail: info@yanhing.com

Yan Hing Machinery(Foshan)Co., Ltd.

Add: 13 Renjing Rd., Yanghe Town, Gaoming District,
Foshan City, P.R. China.

Tel: 0757-8880 3372 Fax: 0757-8880 3329



YH20181123